



Application guide:
MOD-bit systems



Alfacing International Limited

Before we begin.

For over 30 years our Canadian family owned business has been a leading manufacturer of top quality construction materials. Our broad range of products and wall systems are subjected to extensive research and rigorous testing to ensure that they not only meet the Canadian Building Code requirements, but exceed them. Recognized as a leader in innovation, DuROCK has realized that green construction materials are now setting new standards in the building industry. With construction costs on the rise, energy efficient applications are going to play a key role in the future of building envelopes. As a manufacturer we not only play an important part in providing exceptional quality in products, but also a responsibility in quality control and the sustainability of our environment.

What is.....



COOLFLEX, is a high-strength elastomeric coating that provides the ultimate in reflectivity, and weather resistance over new or existing roof surfaces. Although it is highly flexible, it exhibits a tough, enamel-like finish that resists abrasion, biological growth, dirt and all types of weather extremes.



Why is beneficial to building owners and managers...

- Can be applied to many suitable existing roofing substrates including : BUR, Mod-bit, Concrete and Asphalt.
- Reflects 89% of the sun's harmful UV rays.
- Made to withstand Canada's extreme climate.
- Reduces the temperature inside the building it covers by 6-9 degrees.
- Reduces the roof surface temperature by 20-60 degrees.
- Increases the effective "R" value of insulation.
- Increases the efficiency of roof-mounted HVAC units.
- Saves on air conditioning costs.
- Results in lower energy costs overall to your building by reducing your 'peak electrical demand level.
- Slows premature aging of a roof due to high surface temperature and UV degradation.
- Water based products, no harmful chemicals (GREEN).
- Energy Star accredited.
- LEED credit 7.2 (Reduces the heat-island effect).
- Reduces the 'Heat-Island effect' which results in substantial savings.
- Complies with the 'ECO-ROOF' program grant from City of Toronto.



Application Process:

Step # 1 :

Ensure the new or existing Mod-bit system is correctly installed as per manufacturers specifications. Any leaks must be addressed and fixed before the installation of the COOLFLEX system.

Step # 2 :

Ensure the substrate is clean and free of any dirt, debris and residue. A light rinse and sweep is recommended. Ensure that the substrate is clean & dry prior to step #3.

Suitable, existing 2 or 4 ply Mod-bit system.

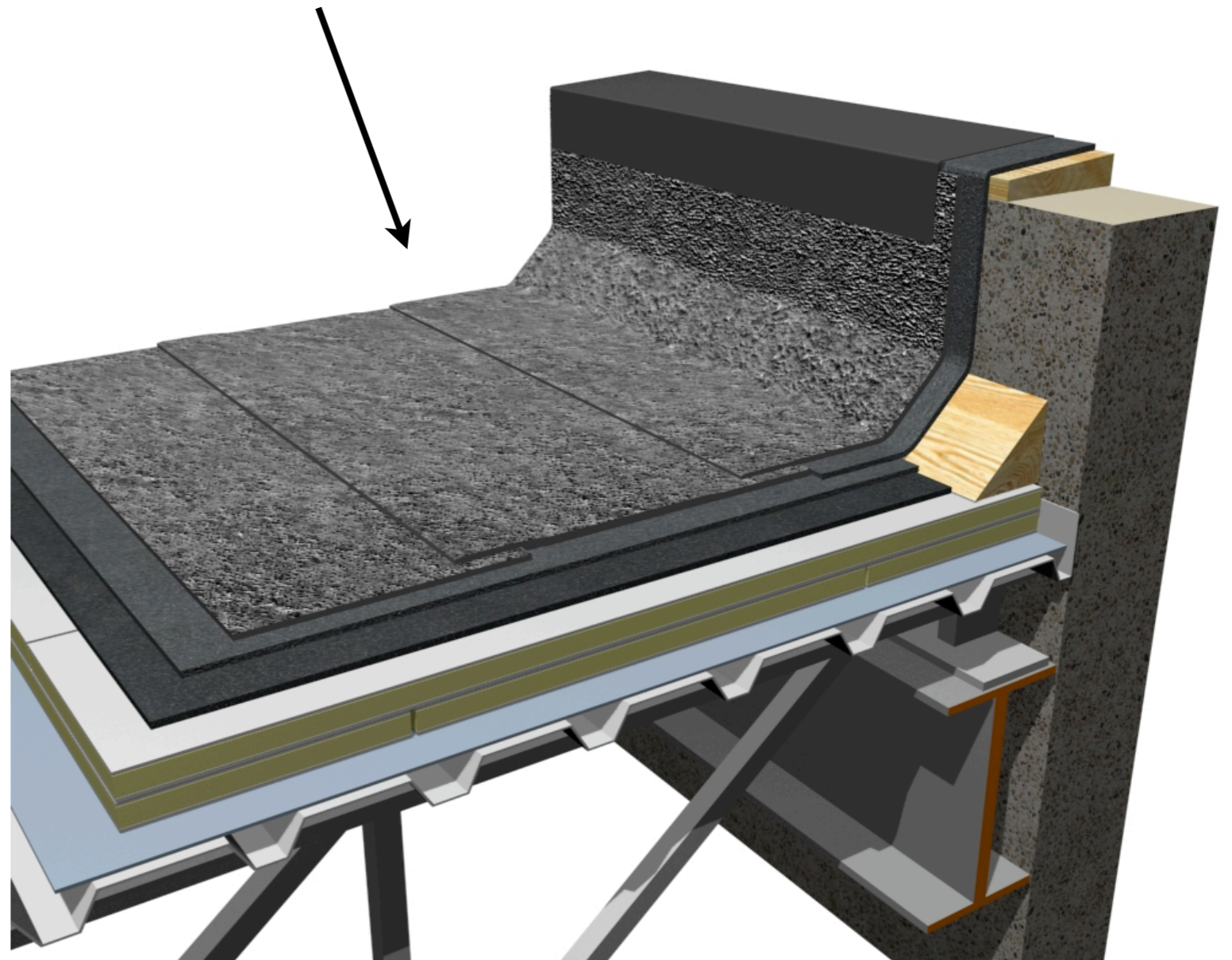

Application Process:

Step # 3 :

Apply COOLFLEX to all exposed laps at a thickness of 20mils (high-pile roller or spray system). Ensure that there is an overlap of 2 inches on each side of the cap sheet of COOLFLEX. Let dry for 6-8 hours depending on weather conditions.

(Suitable, existing 2 or 4 ply Mod-bit system with COOLFLEX applied to cap sheets.)

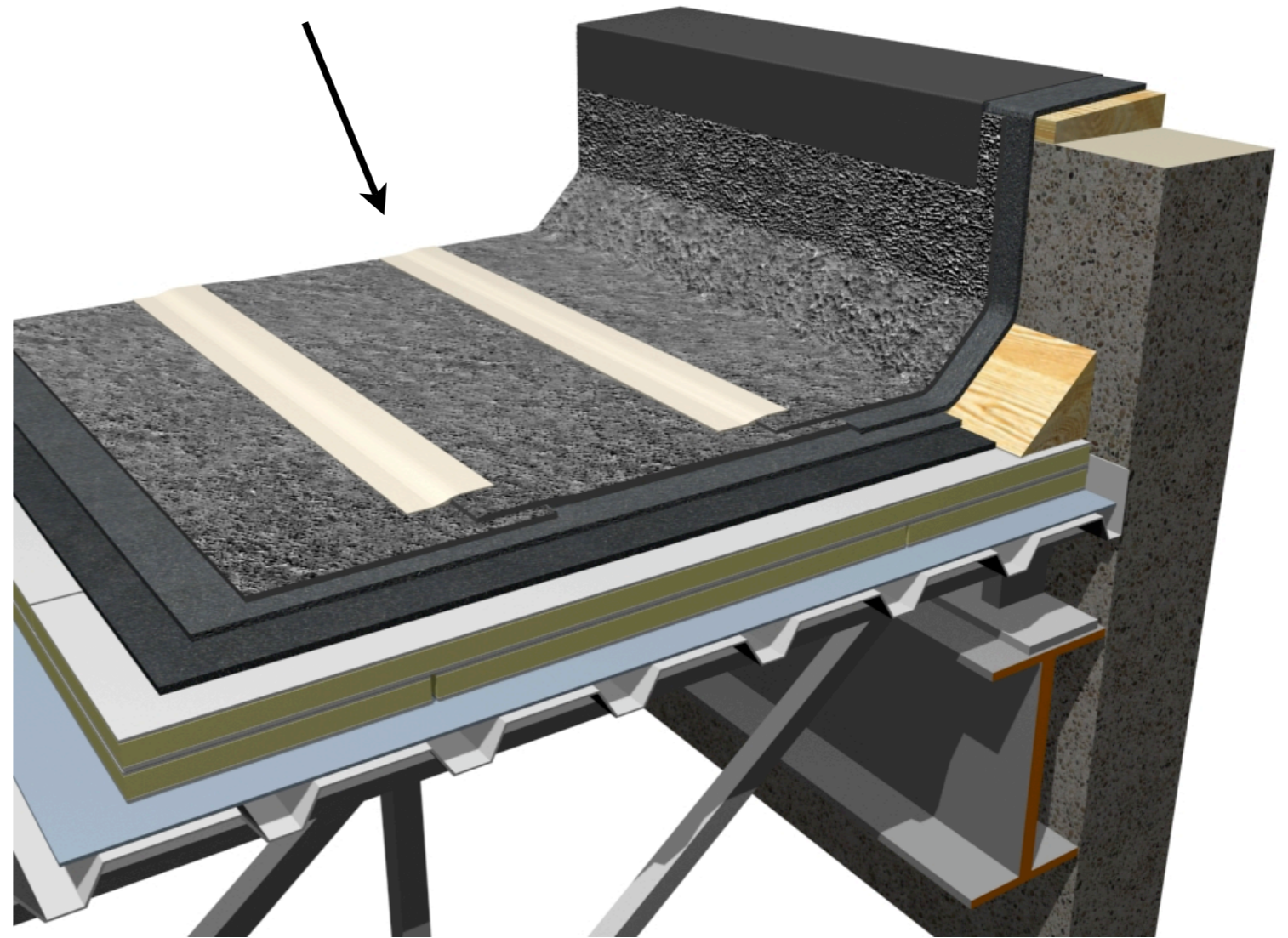

Application Process:

Step # 4 :

Ensure substrate is clean and dry. Apply 1st coat of COOLFLEX using a high-pile roller or spray system (2500-3000psi) using .025-.041 thou tip at a consistent thickness of 20 mils. Ensure that the entire substrate is covered. Let dry for 6-8 hours.

(Suitable, existing 2 or 4 ply Mod-bit system with COOLFLEX applied to cap sheets + 1st coat of COOLFLEX.)

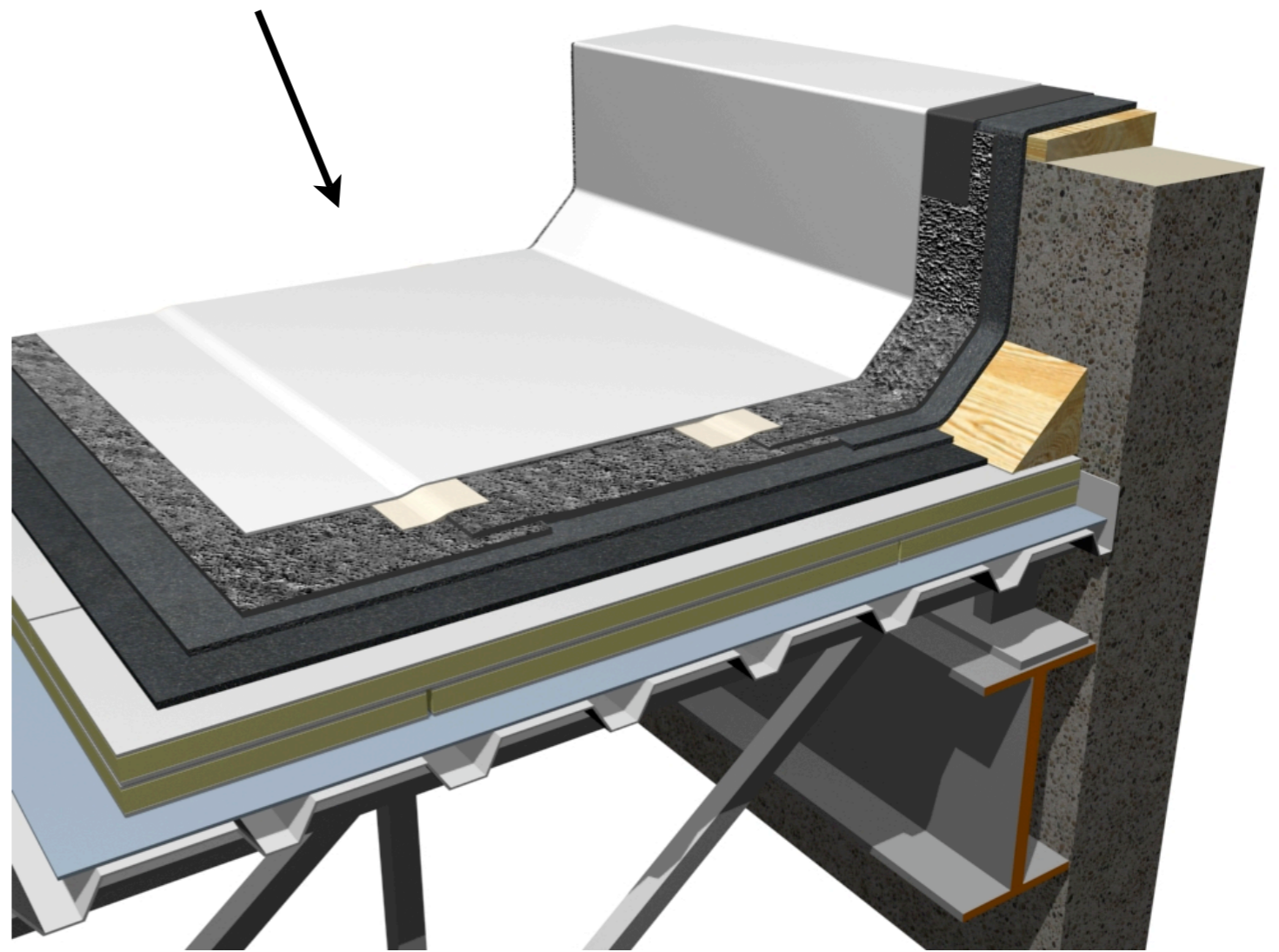

Application Process:

Step # 5 :

Ensure substrate is clean and dry. Apply the 2nd coat TioCOAT using a high-pile roller or spray system (2500-3000psi) using .025-.041 thou tip at a consistent thickness of 20 mils. Ensure that the entire substrate and 1st coat of COOLFLEX is covered. Let dry for 6-8 hours.

(Suitable, existing 2 or 4 ply Mod-bit system with COOLFLEX applied to cap sheets + 1st coat + 2nd coat of COOLFLEX.)

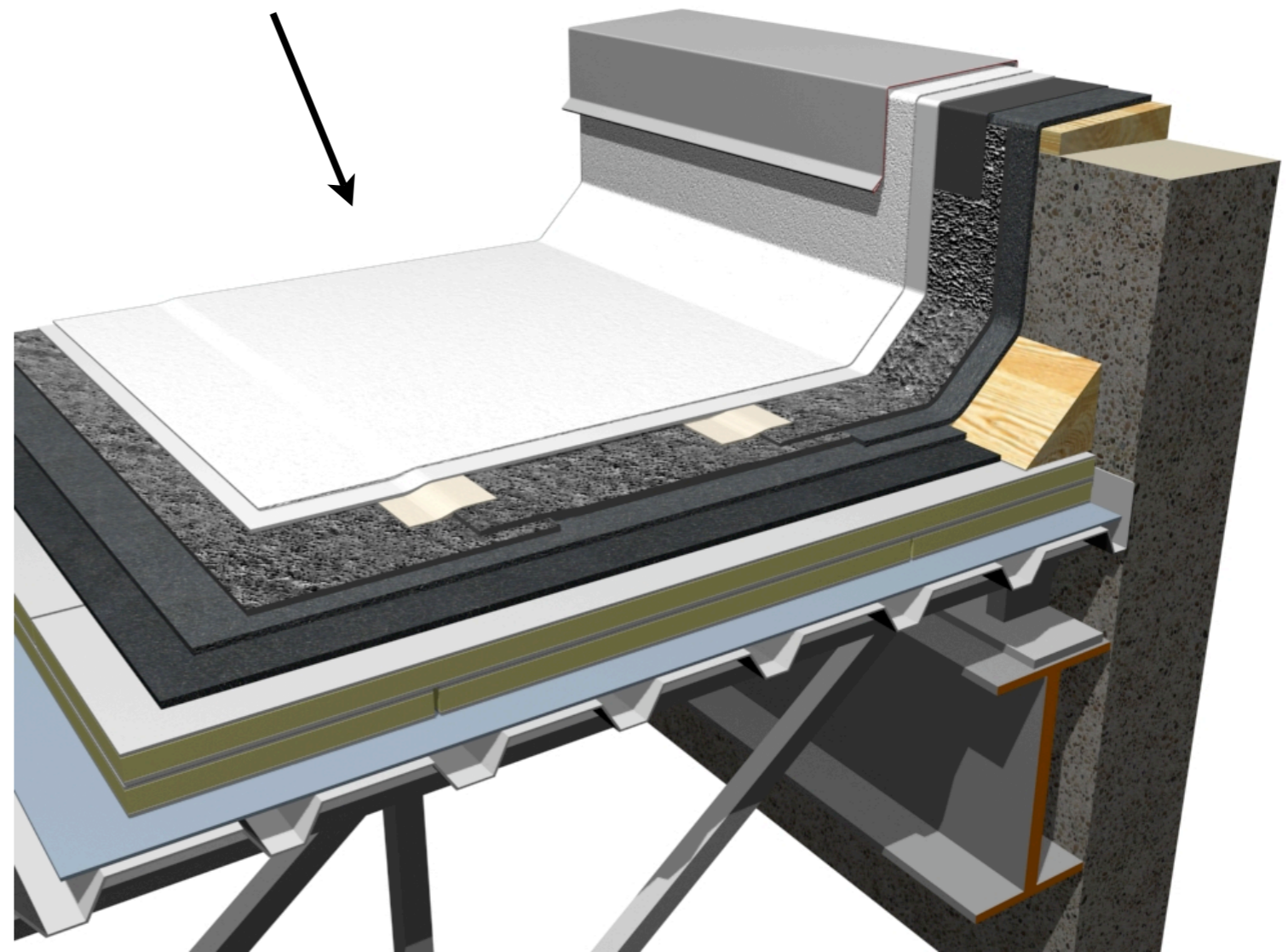

Ensure that all drains, openings, curbs and flashings are installed correctly as per manufacturers recommendations

Application Process:

Step # 6:

Application is now complete. The attached details are only examples, your finished product should not have any Mod-bit or 1st coat of TioCOAT exposed.

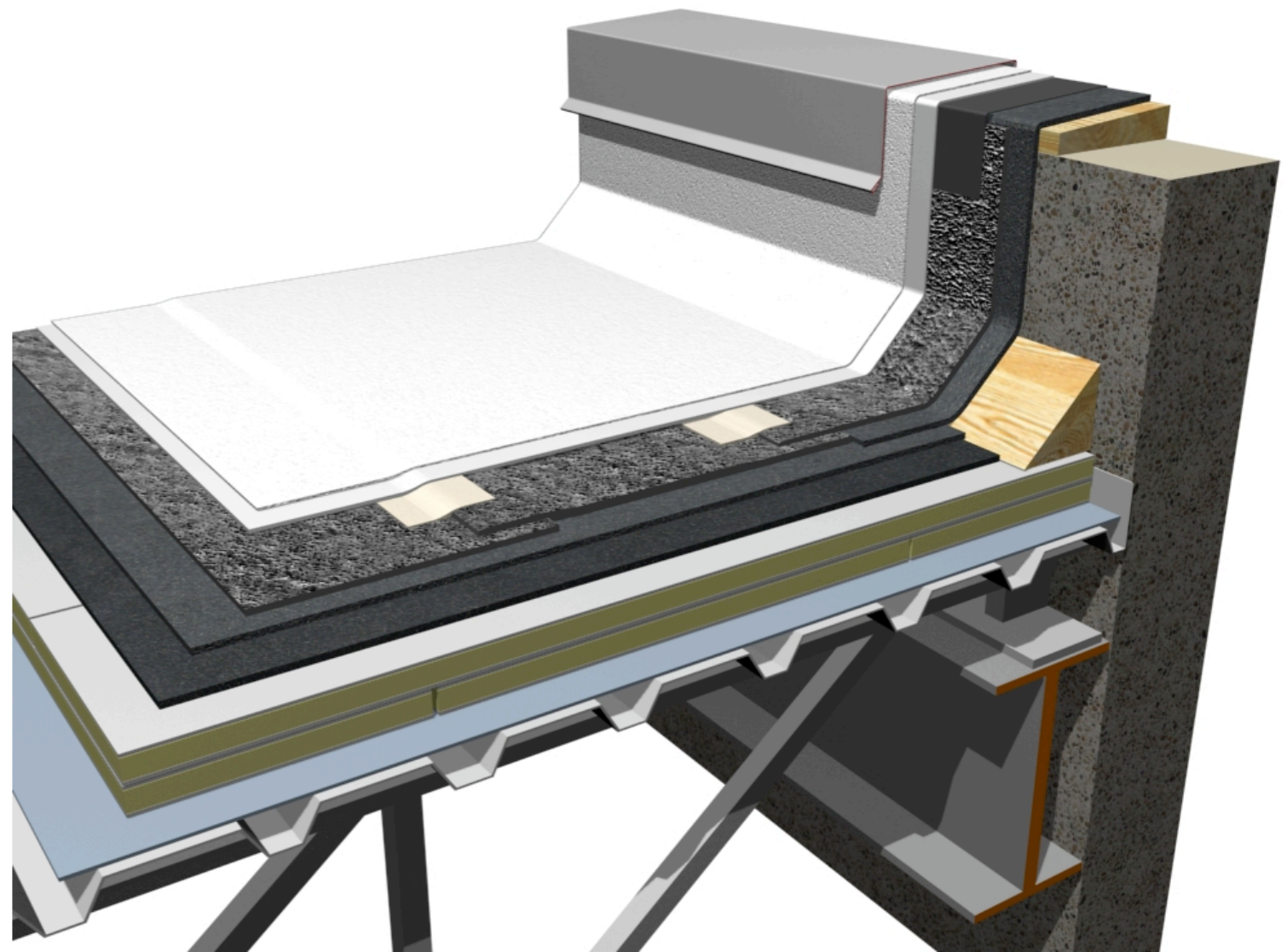

Ensure that all drains, openings, curbs and flashings are installed correctly as per manufacturers recommendations